

*Engineering
Your
Competitive
Edge[®]*



Anwendungsspezifische Werkzeuge

TOP NOTCH Profiling **D2**

KENNA PERFECT	D2
Wendeschneidplatten	D4
Klemmhalter	D9
Bohrstangen und -köpfe	D14

K-LOCK **D18**

Wendeschneidplatten	D18
Klemmhalter	D20

KENDEX Mini **D22**

Wendeschneidplatten	D22
Bohrstangen	D24



1. Schritt – Wahl der Spanformstufe

Negative Wendeschneidplatten

▼ Schruppen



K..X-32

▼▼ Mittlere Bearbeitung



K..X-25, K..X-20,
K..X-15

▼▼▼ Schlichten



KCGR

▼▼▼ Schlichten



K.G.-08, K.G.-15, K.G.-20

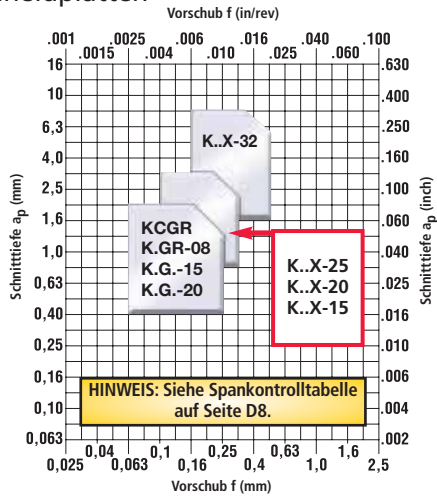

Positive Wendeschneidplatten

▼▼ Mittlere Bearbeitung



VCMR

▼▼▼ Schlichten



.CGR, VBMR

▼▼▼ Schlichten



VCGN

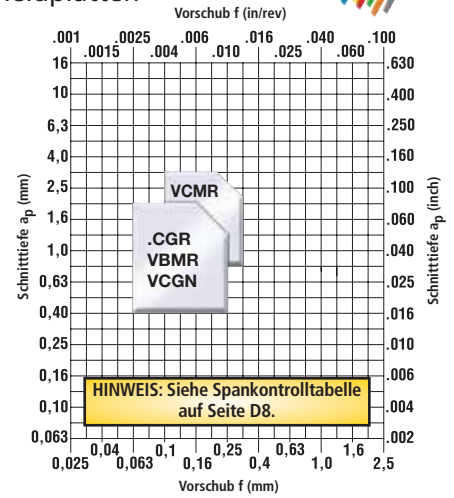

2. Schritt – Wahl des Schneidstoffes

Schnittbedingung	Stahl			Nicht rostender Stahl		
	▼▼▼	▼▼	▼	▼▼▼	▼▼	▼
stark unterbrochener Schnitt	⚙️ KC9125	KC8050	KC8050	KC9225	KC8050	KC8050
leicht unterbrochener Schnitt	⚙️ KC9110	KC9125	KC8050	KC5010	KC5025	KC5025
schwankende Schnitttiefe, Guss- oder Schmiedehaut	⚙️ KT315	KC9125	KC9125	KT315	KC9225	KC9225
glatter Schnitt, vorbearbeitete Oberfläche	⚙️ KT315	KC9110	KC9110	KT315	KC5010	KC9225

Schnittbedingung	Gusseisen			NE-Metalle		
	▼▼▼	▼▼	▼	▼▼▼	▼▼	▼
stark unterbrochener Schnitt	⚙️ KC9315	KC8050	KC8050	KC5010	KC5010	KC5010
leicht unterbrochener Schnitt	⚙️ KC9315	KC9315	KC8050	KC5410/KD100	KC5010	KC5010
schwankende Schnitttiefe, Guss- oder Schmiedehaut	⚙️ KC5010	KC9315	KC9315	KD100/KD1405	KC5410	KC5410
glatter Schnitt, vorbearbeitete Oberfläche	⚙️ KT315	KC5010	KC5010	KD1405	KC5410	KC5410

Schnittbedingung	Schwer zerspanbare Werkstoffe			Harte Werkstoffe		
	▼▼▼	▼▼	▼	▼▼▼	▼▼	▼
stark unterbrochener Schnitt	⚙️ KC5025	K68	K68	–	–	–
leicht unterbrochener Schnitt	⚙️ KC5010/KD120	KC5010	KC8050	KC5010/KB9610	KC5010	KC5010
schwankende Schnitttiefe, Guss- oder Schmiedehaut	⚙️ KD120	KC5010	KC5010	KB9610	KC5010	KC5010
glatter Schnitt, vorbearbeitete Oberfläche	⚙️ KB9610	KC5010	KC5010	KB9610	KB9610	KC5010



3. Schritt – Wahl der Schnittgeschwindigkeit

Stahl

KENNA PERFECT Werkstoffgruppe	Schneidstoff	Geschwindigkeit - m/min (sfm)								Ausgangsbedingungen	
		50 (170)	100 (330)	150 (490)	200 (655)	250 (820)	300 (980)	350 (1150)	400 (1300)	m/min	sfm
P	KT315									260	850
	KC9110									240	800
	KC9125									180	600
	KC8050									165	550

Nicht rostender Stahl

KENNA PERFECT Werkstoffgruppe	Schneidstoff	Geschwindigkeit - m/min (sfm)								Ausgangsbedingungen	
		50 (170)	100 (330)	150 (490)	200 (655)	250 (820)	300 (980)	350 (1150)	400 (1300)	m/min	sfm
M	KT315									230	750
	KC5010									180	600
	KC5025									120	400
	KC9225									170	550
	KC8050									150	500

Gusseisen

KENNA PERFECT Werkstoffgruppe	Schneidstoff	Geschwindigkeit - m/min (sfm)								Ausgangsbedingungen	
		50 (170)	100 (330)	150 (490)	200 (655)	250 (820)	300 (980)	350 (1150)	400 (1300)	m/min	sfm
K	KT315									275	900
	KC5010									245	800
	KC9315									245	800
	KC8050									230	750

NE-Metalle

KENNA PERFECT Werkstoffgruppe	Schneidstoff	Geschwindigkeit - m/min (sfm)								Ausgangsbedingungen	
		250 (800)	500 (1600)	750 (2400)	1000 (3200)	1250 (4000)	1500 (4800)	1750 (5600)	2000 (6400)	m/min	sfm
N	KD100/KD1405									765	2500
	KC5410									550	1800
	KC5010									460	1500
	K68									150	500

Schwer zerspanbare Werkstoffe

KENNA PERFECT Werkstoffgruppe	Schneidstoff	Geschwindigkeit - m/min (sfm)								Ausgangsbedingungen	
		15 (50)	40 (120)	55 (180)	80 (250)	100 (330)	170 (550)	200 (655)	230 (750)	m/min	sfm
S	KB9610									215	700
	KD120									120	400
	KC5010									60	200
	KC5025									50	170
	KC8050									70	230
	K68									30	100

Hartmetall

KENNA PERFECT Werkstoffgruppe	Schneidstoff	Geschwindigkeit - m/min (sfm)								Ausgangsbedingungen	
		15 (50)	40 (120)	55 (180)	80 (250)	100 (330)	170 (550)	200 (655)	230 (750)	m/min	sfm
H	KB9610									150	500
	KC5010									40	130

Stellt die empfohlenen Ausgangsbedingungen dar. Für den jeweiligen Einsatz optimieren.

ANWENDUNGSSPEZIFISCHE WERKZEUGE
KENDEX MINI
K-LOCK
TOP NOTCH PROFILING

TOP NOTCH Profiling Wendeschneidplatten



Schneidstoffauswahl

		KENNA PERFECT																													
		P			M			K		N			S		H																
ISO-Katalognummer		KT315	KC9110	KC9125	KC8050	KT315	KC5010	KC5025	KC9225	KC8050	KT315	KC5010	KC9315	KC8050	KD120	K68	KC5010	KC5410	KD1405	KD100	K68	KC5010	KC5025	KC9225	KC8050	KD120	KC5010	KB9610	KD120		
DCGR KD100 	DCGR150404 DCGR150408 DCGR150412	•	•	•	•	•	•	•	•	•	•	•	•	•	•	•	•	•	•	•	•	•	•	•	•	•	•	•	•		
	KCGR KD100 	Rechts KCGR110304R08 KCGR110308R08 Links KCGR110304L08 KCGR110308L08	•	•	•	•	•	•	•	•	•	•	•	•	•	•	•	•	•	•	•	•	•	•	•	•	•	•	•	•	
KNGX KD100 	Rechts KNGX150401R15 KNGX150402R15 KNGX150404R20 KNGX150408R20 KNGX150408R25 KNGX220404R25 KNGX220408R32 KNGX220408R20 KNGX220408R25	•	•	•	•	•	•	•	•	•	•	•	•	•	•	•	•	•	•	•	•	•	•	•	•	•	•	•	•		
	Links KNGX150401L15 KNGX150402L15 KNGX150404L20 KNGX150408L20 KNGX150408L25 KNGX220404L25 KNGX220408L20 KNGX220408L25 KNGX220408L32	•	•	•	•	•	•	•	•	•	•	•	•	•	•	•	•	•	•	•	•	•	•	•	•	•	•	•	•	•	
	KNUX 	Rechts KNUX150405R20 KNUX150405R25 KNUX150405R32 KNUX150410R20 KNUX150410R25 KNUX150410R32	•	•	•	•	•	•	•	•	•	•	•	•	•	•	•	•	•	•	•	•	•	•	•	•	•	•	•	•	
		Links KNUX150405L20 KNUX150405L25 KNUX150405L32 KNUX150410L20 KNUX150410L25 KNUX150410L32	•	•	•	•	•	•	•	•	•	•	•	•	•	•	•	•	•	•	•	•	•	•	•	•	•	•	•	•	•



TOP NOTCH Profiling Wendeschneidplatten

Abmessungen

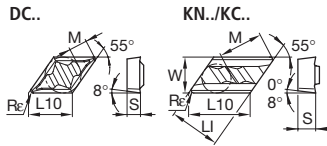

Abmessungen

ISO - Katalognummer	ANSI- Katalognummer	Abmessungen														
		D		W		L10		LI		S		M		RE		
		Zoll	mm	Zoll	mm	Zoll	mm	Zoll	mm	Zoll	mm	Zoll	mm	Zoll	mm	
DCGR150404 DCGR150408 DCGR150412	DPGR431 DPGR432 DPGR433	1/2 1/2 1/2	12,70 12,70 12,70	- - -	- - -	.610 .610 .610	15,50 15,50 15,50	- - -	- - -	3/16 3/16 3/16	4,76 4,76 4,76	.273 .255 .237	6,94 6,48 6,01	1/64 1/32 3/64	0,40 0,80 1,20	DCGR KD100
Rechts KCGR110304R08 KCGR110308R08	NPGR51R NPGR52R	- -	- -	.250 .250	6,35 6,35	.457 .457	11,60 11,60	.375 .375	9,53 9,53	1/8 1/8	3,18 3,18	.358 .341	9,10 8,66	1/64 1/32	0,40 0,80	KCGR KD100
Links KCGR110304L08 KCGR110308L08	NPGR51L NPGR52L	- -	- -	.250 .250	6,35 6,35	.457 .457	11,60 11,60	.375 .375	9,53 9,53	1/8 1/8	3,18 3,18	.358 .341	9,10 8,66	1/64 1/32	0,40 0,80	 KD100
Rechts KNGX150401R15 KNGX150402R15 KNGX150404R20 KNGX150408R20 KNGX150408R25 KNGX220404R25 KNGX220408R32 KNGX220408R20 KNGX220408R25	NPR1305 NPR1308 NPR131F NPR132F NPR132N NPR331N NPR332 NPR332F NPR332N	- - - - - - - - - -	- - - - - - - - - -	.375 .375 .375 .375 .375 .375 .375 .375 .375 .375	9,53 9,53 9,53 9,53 9,53 9,53 9,53 9,53 9,53 9,53	.608 .608 .608 .608 .608 .895 .895 .895 .895 .895	15,44 15,44 15,44 15,44 15,44 22,73 22,73 22,73 22,73 22,73	.500 .500 .500 .500 .500 .733 .733 .733 .733 .733	12,70 12,70 12,70 12,70 12,70 18,62 18,62 18,62 18,62 18,62	3/16 3/16 3/16 3/16 3/16 3/16 3/16 3/16 3/16 3/16	4,76 4,76 4,76 4,76 4,76 4,76 4,76 4,76 4,76 4,76	.542 .538 .529 .511 .511 .784 .767 .767 .767 .767	13,76 13,67 13,44 12,98 12,98 19,91 19,47 19,47 19,47 19,47	.005 .008 1/64 1/32 1/32 1/64 1/32 1/32 1/32 1/32	0,13 0,20 0,40 0,80 0,80 0,40 0,80 0,80 0,80 0,80	KNGX KD100
Links KNGX150401L15 KNGX150402L15 KNGX150404L20 KNGX150408L20 KNGX150408L25 KNGX220404L25 KNGX220408L20 KNGX220408L25 KNGX220408L32	NPL1305 NPL1308 NPL131F NPL132F NPL132N NPL331N NPL332F NPL332N NPL332	- - - - - - - - - -	- - - - - - - - - -	.375 .375 .375 .375 .375 .375 .375 .375 .375 .375	9,53 9,53 9,53 9,53 9,53 9,53 9,53 9,53 9,53 9,53	.608 .608 .608 .608 .608 .895 .895 .895 .895 .895	15,44 15,44 15,44 15,44 15,44 22,73 22,73 22,73 22,73 22,73	.500 .500 .500 .500 .500 .733 .733 .733 .733 .733	12,70 12,70 12,70 12,70 12,70 18,62 18,62 18,62 18,62 18,62	3/16 3/16 3/16 3/16 3/16 3/16 3/16 3/16 3/16 3/16	4,76 4,76 4,76 4,76 4,76 4,76 4,76 4,76 4,76 4,76	.542 .538 .529 .511 .511 .784 .767 .767 .767 .767	13,76 13,67 13,44 12,98 12,98 19,91 19,47 19,47 19,47 19,47	.005 .008 1/64 1/32 1/32 1/64 1/32 1/32 1/32 1/32	0,13 0,20 0,40 0,80 0,80 0,40 0,80 0,80 0,80 0,80	 KD100
Rechts KNUX150405R20 KNUX150405R25 KNUX150405R32 KNUX150410R20 KNUX150410R25 KNUX150410R32	NPR13M05F NPR13M05N NPR13M05R NPR13M10F NPR13M10N NPR13M10R	- - - - - -	- - - - - -	.375 .375 .375 .375 .375 .375	9,53 9,53 9,53 9,53 9,53 9,53	.608 .608 .608 .608 .608 .608	15,44 15,44 15,44 15,44 15,44 15,44	.500 .500 .500 .500 .500 .500	12,70 12,70 12,70 12,70 12,70 12,70	3/16 3/16 3/16 3/16 3/16 3/16	4,76 4,76 4,76 4,76 4,76 4,76	.525 .525 .525 .502 .502 .502	13,32 13,32 13,32 12,74 12,74 12,74	.020 .020 .020 .039 .039 .039	0,50 0,50 0,50 1,00 1,00 1,00	KNUX
Links KNUX150405L20 KNUX150405L25 KNUX150405L32 KNUX150410L20 KNUX150410L25 KNUX150410L32	NPL13M05F NPL13M05N NPL13M05R NPL13M10F NPL13M10N NPL13M10R	- - - - - -	- - - - - -	.375 .375 .375 .375 .375 .375	9,53 9,53 9,53 9,53 9,53 9,53	.608 .608 .608 .608 .608 .608	15,44 15,44 15,44 15,44 15,44 15,44	.500 .500 .500 .500 .500 .500	12,70 12,70 12,70 12,70 12,70 12,70	3/16 3/16 3/16 3/16 3/16 3/16	4,76 4,76 4,76 4,76 4,76 4,76	.525 .525 .525 .502 .502 .502	13,32 13,32 13,32 12,74 12,74 12,74	.020 .020 .020 .039 .039 .039	0,50 0,50 0,50 1,00 1,00 1,00	 KD100

Bestellbeispiel:
ISO-Katalognummer: DCGR150404
Schneidstoffsorte: KT315

TOP NOTCH PROFILING
 K-LOCK
 KENDEX MINI
 ANWENDUNGSSPEZIFISCHE WERKZEUGE

TOP NOTCH Profiling Wendeschneidplatten



Schneidstoffauswahl

TOP NOTCH PROFILING

K-LOCK

KENDEX MINI

ANWENDUNGSSPEZIFISCHE WERKZEUGE

		KENNA PERFECT																												
		P			M				K			N		S			H													
ISO-Katalognummer		KT315	KC9110	KC9125	KC8050	KT315	KC5010	KC5025	KC9225	KC8050	KT315	KC5010	KC9315	KC8050	KD120	K68	KC5010	KC5410	KD1405	KD100	K68	KC5010	KC5025	KC9225	KC8050	KD120	KC5010	KB9610	KD120	
<p>KCGX</p>	KCGX110301R15	•	•	•	•	•	•	•	•	•	•	•	•	•	•	•	•	•	•	•	•	•	•	•	•	•	•	•	•	
	KCGX110302R15	•	•	•	•	•	•	•	•	•	•	•	•	•	•	•	•	•	•	•	•	•	•	•	•	•	•	•	•	•
	KCGX110304R15	•	•	•	•	•	•	•	•	•	•	•	•	•	•	•	•	•	•	•	•	•	•	•	•	•	•	•	•	•
	KCGX110308R15	•	•	•	•	•	•	•	•	•	•	•	•	•	•	•	•	•	•	•	•	•	•	•	•	•	•	•	•	•
<p>KD100 KD120 KD1405 KB9610</p>	KCGX110301L15	•	•	•	•	•	•	•	•	•	•	•	•	•	•	•	•	•	•	•	•	•	•	•	•	•	•	•	•	
	KCGX110302L15	•	•	•	•	•	•	•	•	•	•	•	•	•	•	•	•	•	•	•	•	•	•	•	•	•	•	•	•	•
	KCGX110304L15	•	•	•	•	•	•	•	•	•	•	•	•	•	•	•	•	•	•	•	•	•	•	•	•	•	•	•	•	•
	KCGX110308L15	•	•	•	•	•	•	•	•	•	•	•	•	•	•	•	•	•	•	•	•	•	•	•	•	•	•	•	•	•
<p>KCUX</p> <p>Rechts KCUX110302R15 KCUX110305R15 KCUX110310R15</p> <p>Links KCUX110302L15 KCUX110305L15 KCUX110310L15</p>	KCUX110302R15	•	•	•	•	•	•	•	•	•	•	•	•	•	•	•	•	•	•	•	•	•	•	•	•	•	•	•	•	
	KCUX110305R15	•	•	•	•	•	•	•	•	•	•	•	•	•	•	•	•	•	•	•	•	•	•	•	•	•	•	•	•	•
	KCUX110310R15	•	•	•	•	•	•	•	•	•	•	•	•	•	•	•	•	•	•	•	•	•	•	•	•	•	•	•	•	•
	KCUX110302L15	•	•	•	•	•	•	•	•	•	•	•	•	•	•	•	•	•	•	•	•	•	•	•	•	•	•	•	•	•
<p>KCGN</p> <p>Rechts KCGN110304R08E KCGN110308R08E</p> <p>Links KCGN110304L08E KCGN110308L08E</p>	KCGN110304R08E	•	•	•	•	•	•	•	•	•	•	•	•	•	•	•	•	•	•	•	•	•	•	•	•	•	•	•	•	
	KCGN110308R08E	•	•	•	•	•	•	•	•	•	•	•	•	•	•	•	•	•	•	•	•	•	•	•	•	•	•	•	•	•
	KCGN110304L08E	•	•	•	•	•	•	•	•	•	•	•	•	•	•	•	•	•	•	•	•	•	•	•	•	•	•	•	•	•
	KCGN110308L08E	•	•	•	•	•	•	•	•	•	•	•	•	•	•	•	•	•	•	•	•	•	•	•	•	•	•	•	•	•
<p>VBMR</p> <p>VBMR110302 VBMR110304 VBMR110308</p>	VBMR110302	•	•	•	•	•	•	•	•	•	•	•	•	•	•	•	•	•	•	•	•	•	•	•	•	•	•	•	•	
	VBMR110304	•	•	•	•	•	•	•	•	•	•	•	•	•	•	•	•	•	•	•	•	•	•	•	•	•	•	•	•	•
	VBMR110308	•	•	•	•	•	•	•	•	•	•	•	•	•	•	•	•	•	•	•	•	•	•	•	•	•	•	•	•	•
<p>VCMR</p> <p>VCMR160404 VCMR160408</p>	VCMR160404	•	•	•	•	•	•	•	•	•	•	•	•	•	•	•	•	•	•	•	•	•	•	•	•	•	•	•	•	
	VCMR160408	•	•	•	•	•	•	•	•	•	•	•	•	•	•	•	•	•	•	•	•	•	•	•	•	•	•	•	•	•
<p>VCGN</p> <p>VCGN160404 VCGN160408 VCGN160412</p> <p>KD100 KD120</p>	VCGN160404	•	•	•	•	•	•	•	•	•	•	•	•	•	•	•	•	•	•	•	•	•	•	•	•	•	•	•	•	
	VCGN160408	•	•	•	•	•	•	•	•	•	•	•	•	•	•	•	•	•	•	•	•	•	•	•	•	•	•	•	•	•
	VCGN160412	•	•	•	•	•	•	•	•	•	•	•	•	•	•	•	•	•	•	•	•	•	•	•	•	•	•	•	•	•
	KD100 KD120	•	•	•	•	•	•	•	•	•	•	•	•	•	•	•	•	•	•	•	•	•	•	•	•	•	•	•	•	•
<p>VCGR</p> <p>VCGR160402 VCGR160404 VCGR160408 VCGR160412 VCGR160416</p> <p>KD100</p>	VCGR160402	•	•	•	•	•	•	•	•	•	•	•	•	•	•	•	•	•	•	•	•	•	•	•	•	•	•	•	•	
	VCGR160404	•	•	•	•	•	•	•	•	•	•	•	•	•	•	•	•	•	•	•	•	•	•	•	•	•	•	•	•	•
	VCGR160408	•	•	•	•	•	•	•	•	•	•	•	•	•	•	•	•	•	•	•	•	•	•	•	•	•	•	•	•	•
	VCGR160412	•	•	•	•	•	•	•	•	•	•	•	•	•	•	•	•	•	•	•	•	•	•	•	•	•	•	•	•	•
	VCGR160416	•	•	•	•	•	•	•	•	•	•	•	•	•	•	•	•	•	•	•	•	•	•	•	•	•	•	•	•	•
KD100	•	•	•	•	•	•	•	•	•	•	•	•	•	•	•	•	•	•	•	•	•	•	•	•	•	•	•	•	•	



TOP NOTCH Profiling Wendeschneidplatten

Abmessungen

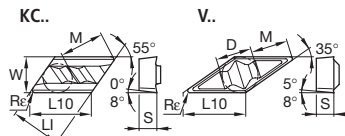

		Abmessungen														
ISO-Katalognummer	ANSI-Katalognummer	D		W		L10		LI		S		M		Rε		
		Zoll	mm	Zoll	mm	Zoll	mm	Zoll	mm	Zoll	mm	Zoll	mm	Zoll	mm	
KCGX110301R15	NPR505	-	-	.250	6,35	.457	11,60	.375	9,53	1/8	3,18	.369	9,38	.005	0,13	
KCGX110302R15	NPR508	-	-	.250	6,35	.457	11,60	.375	9,53	1/8	3,18	.369	9,36	.008	0,20	
KCGX110304R15	NPR51	-	-	.250	6,35	.457	11,60	.375	9,53	1/8	3,18	.360	9,13	1/64	0,40	
KCGX110308R15	NPR52	-	-	.250	6,35	.457	11,60	.375	9,53	1/8	3,18	.340	8,64	1/32	0,80	
KCGX110301L15	NPL505	-	-	.250	6,35	.457	11,60	.375	9,53	1/8	3,18	.369	9,38	.005	0,13	
KCGX110302L15	NPL508	-	-	.250	6,35	.457	11,60	.375	9,53	1/8	3,18	.369	9,36	.008	0,20	
KCGX110304L15	NPL51	-	-	.250	6,35	.457	11,60	.375	9,53	1/8	3,18	.360	9,13	1/64	0,40	
KCGX110308L15	NPL52	-	-	.250	6,35	.457	11,60	.375	9,53	1/8	3,18	.340	8,64	1/32	0,80	
Rechts																
KCUX110302R15	NPR5M02	-	-	.250	6,35	.457	11,60	.375	9,53	1/8	3,18	.367	9,32	.008	0,20	
KCUX110305R15	NPR5M05	-	-	.250	6,35	.457	11,60	.375	9,53	1/8	3,18	.353	8,97	.020	0,50	
KCUX110310R15	NPR5M10	-	-	.250	6,35	.457	11,60	.375	9,53	1/8	3,18	.330	8,39	.039	1,00	
Links																
KCUX110302L15	NPL5M02	-	-	.250	6,35	.457	11,60	.375	9,53	1/8	3,18	.367	9,32	.008	0,20	
KCUX110305L15	NPL5M05	-	-	.250	6,35	.457	11,60	.375	9,53	1/8	3,18	.353	8,97	.020	0,50	
KCUX110310L15	NPL5M10	-	-	.250	6,35	.457	11,60	.375	9,53	1/8	3,18	.330	8,39	.039	1,00	
Rechts																
KCGN110304R08E	NPGN51RE	-	-	.250	6,35	.457	11,60	.375	9,53	1/8	3,18	.358	9,10	1/64	0,40	
KCGN110308R08E	NPGN52RE	-	-	.250	6,35	.457	11,60	.375	9,53	1/8	3,18	.341	8,66	1/32	0,80	
Links																
KCGN110304L08E	NPGN51LE	-	-	.250	6,35	.457	11,60	.375	9,53	1/8	3,18	.358	9,10	1/64	0,40	
KCGN110308L08E	NPGN52LE	-	-	.250	6,35	.457	11,60	.375	9,53	1/8	3,18	.341	8,66	1/32	0,80	
Rechts																
VBMR110302	VBMR2205	1/4	6,35	-	-	.436	11,07	-	-	1/8	3,18	.272	6,91	.008	0,20	
VBMR110304	VBMR221	1/4	6,35	-	-	.436	11,07	-	-	1/8	3,18	.254	6,46	1/64	0,40	
VBMR110308	VBMR222	1/4	6,35	-	-	.436	11,07	-	-	1/8	3,18	.218	5,54	1/32	0,80	
Links																
VCMR160404	VCMR331	3/8	9,53	-	-	.654	16,61	-	-	3/16	4,76	.400	10,15	1/64	0,40	
VCMR160408	VCMR332	3/8	9,53	-	-	.654	16,61	-	-	3/16	4,76	.363	9,23	1/32	0,80	
Rechts																
VCGN160404	VPGN331	3/8	9,53	-	-	.654	16,61	-	-	3/16	4,76	.400	10,15	1/64	0,40	
VCGN160408	VPGN332	3/8	9,53	-	-	.654	16,61	-	-	3/16	4,76	.363	9,23	1/32	0,80	
VCGN160412	VPGN333	3/8	9,53	-	-	.654	16,61	-	-	3/16	4,76	.327	8,31	3/64	1,20	
Links																
VCGR160402	VPGR3305	3/8	9,53	-	-	.654	16,61	-	-	3/16	4,76	.417	10,60	.008	0,20	
VCGR160404	VPGR331	3/8	9,53	-	-	.654	16,61	-	-	3/16	4,76	.400	10,15	1/64	0,40	
VCGR160408	VPGR332	3/8	9,53	-	-	.654	16,61	-	-	3/16	4,76	.363	9,23	1/32	0,80	
VCGR160412	VPGR333	3/8	9,53	-	-	.654	16,61	-	-	3/16	4,76	.327	8,31	3/64	1,20	
VCGR160416	VPGR334	3/8	9,53	-	-	.654	16,61	-	-	3/16	4,76	.291	7,38	1/16	1,60	
Rechts																
Links																
Rechts																
Links																

Bestellbeispiel:
 ISOI-Katalognummer: KCGX110301R15
 Schneidstoffsorte: KT315

TOP NOTCH PROFILING
 K-LOCK
 KENDEX MINI
 ANWENDUNGSSPEZIFISCHE WERKZEUGE

Bearbeitung	Wendeschneidplatten-Ausführung Anwendungsbereich	Spanformstufe	Profil	Vorschub – (mm)																					
				0,04	0,063	0,01	0,16	0,25	0,4	0,63	1,0	1,6	2,5	5,0											
				0,1	0,16	0,25	0,4	0,63	1,0	1,6	2,5	4,0	6,3	10,0											
				Schnitttiefe – (mm)																					
Schlichten ▼▼▼	DPGR präzisionsgeschliffen							0,1 - 0,3 (.004 - .012)																	
Schlichten ▼▼▼	KCGR präzisionsgeschliffen							0,1 - 0,3 (.004 - .012)																	
Schlichten ▼▼▼	VBMR							0,1 - 0,4 (.004 - .014)																	
Schlichten ▼▼▼	VCGR präzisionsgeschliffen							0,1 - 0,4 (.004 - .014)																	
Schlichten ▼▼▼	KNGX-15							0,2 - 0,4 (.006 - .016)													0,8 - 2,8 (.030 - .110)				
mittlere Bearbeitung ▼▼	KNGX-20							0,2 - 0,5 (.008 - .018)													1,0 - 3,0 (.040 - .120)				
mittlere Bearbeitung ▼▼	KNGX-25							0,3 - 0,6 (.010 - .022)													1,1 - 3,6 (.045 - .140)				
Schruppen ▼	KNGX-32							0,3 - 0,7 (.012 - .026)													1,5 - 5,1 (.060 - .200)				
				Vorschub – Zoll																					
				.0015	.0025	.004	.006	.010	.016	.025	.040	.060	.100	.200											
				.004	.006	.010	.016	.025	.040	.060	.100	.160	.250	.500	Schnitttiefe – Zoll										



NKLC 95°

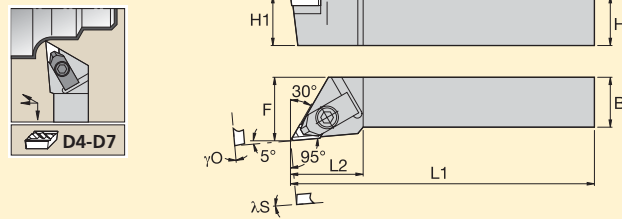

NKLC-F 95°

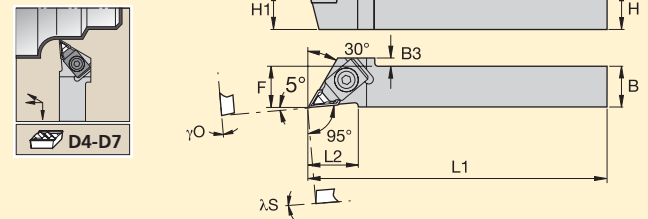

ISO-Katalognummer	H =			L1	L2	B3	λS°	γO°	Wende-schneid-platte	Unter-lage	Schraube für Unter-lage	Hex (mm)	Spann-element	Schraube für Spann-element	Hex (mm)
	H1	B	F												
Rechts															
NKLCR1212F11	12	12	16,0	80	24,0	-	0,0	0,0	KC..110305R	SM885	MS959	-	CM68	MS524	3
NKLCR1616H11	16	16	20,0	100	24,0	-	0,0	0,0	KC..110305R	SM885	MS959	-	CM68	MS524	3
NKLCR2020K11	20	20	25,0	125	24,0	-	0,0	0,0	KC..110305R	SM885	MS959	-	CM68	MS524	3
NKLCR2525M11	25	25	32,0	150	24,0	-	0,0	0,0	KC..110305R	SM885	MS959	-	CM68	MS524	3
Links															
NKLCL1212F11	12	12	16,0	80	24,0	-	0,0	0,0	KC..110305L	SM886	MS959	-	CM68	MS524	3
NKLCL1616H11	16	16	20,0	100	24,0	-	0,0	0,0	KC..110305L	SM886	MS959	-	CM68	MS524	3
NKLCL2020K11	20	20	25,0	125	24,0	-	0,0	0,0	KC..110305L	SM886	MS959	-	CM68	MS524	3
NKLCL2525M11	25	25	32,0	150	24,0	-	0,0	0,0	KC..110305L	SM886	MS959	-	CM68	MS524	3
Rechts															
NKLCRF1212M11Q	12	12	12,0	150	24,0	-	0,0	0,0	KC..110305R	SM885	MS959	-	CM180	MS524	3
NKLCRF1616K11Q	16	16	16,0	125	24,0	-	0,0	0,0	KC..110305R	SM885	MS959	-	CM180	MS524	3
Links															
NKLCLF1212M11Q	12	12	12,0	150	24,0	-	0,0	0,0	KC..110305L	SM886	MS959	-	CM180	MS524	3
NKLCLF1616K11Q	16	16	16,0	125	24,0	-	0,0	0,0	KC..110305L	SM886	MS959	-	CM180	MS524	3

NKLN 95°

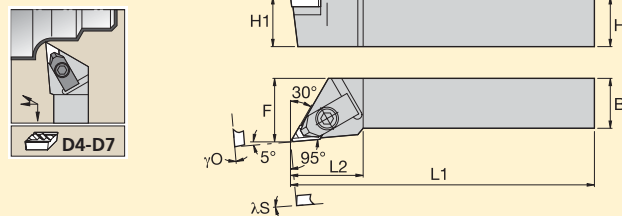

NKNC 63°

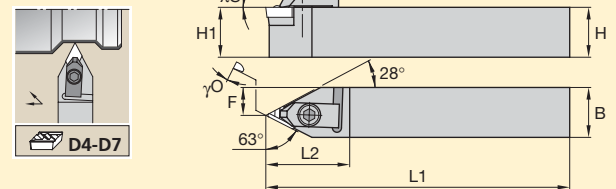

ISO-Katalognummer	H =			L1	L2	B3	λS°	γO°	Wende-schneid-platte	Unter-lage	Schraube für Unter-lage	Hex (mm)	Spann-element	Schraube für Spann-element	Hex (mm)
	H1	B	F												
Rechts															
NKLN2020K15	20	20	25,0	125	32,0	-	-2,0	-5,0	KN..150410R	SM872	MS111	2	CM66	MS625	4
NKLN2525M15	25	25	32,0	150	32,0	-	-2,0	-5,0	KN..150410R	SM872	MS111	2	CM66	MS625	4
NKLN3225P15	32	25	32,0	170	32,0	-	-2,0	-5,0	KN..150410R	SM872	MS111	2	CM66	MS625	4
Links															
NKLN2020K15	20	20	25,0	125	32,0	-	-2,0	-5,0	KN..150410L	SM871	MS111	2	CM66	MS625	4
NKLN2525M15	25	25	32,0	150	32,0	-	-2,0	-5,0	KN..150410L	SM871	MS111	2	CM66	MS625	4
NKLN3225P15	32	25	32,0	170	32,0	-	-2,0	-5,0	KN..150410L	SM871	MS111	2	CM66	MS625	4
Rechts															
NKNCR1616H11	16	16	9,0	100	27,0	-	0,0	0,0	KC..110305R	SM885	MS959	-	CM68	MS524	3
Links															
NKNCCL1616H11	16	16	9,0	100	27,0	-	0,0	0,0	KC..110305L	SM886	MS959	-	CM68	MS524	3

Bestellbeispiel:
Rechts: NKLCR1212F11

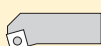

Links: NKLCL1212F11



TOP NOTCH PROFILING



Klemmhalter

NKNN 63°

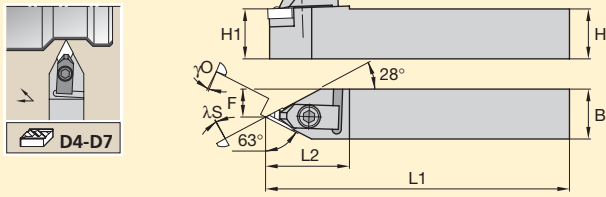

NKXC 120°

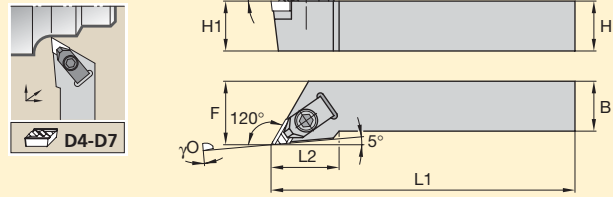

ISO-Katalognummer	H = H1	B	F	L1	L2	B3	λS°	γ0°	Wende- schneid- platte	Unter- lage	Schraube für Unter- lage Hex (mm)	Spann- element	Schraube für Spann- element Hex (mm)		
Rechts															
NKNNR2020K15	20	20	12,0	125	37,0	-	-2,0	-5,0	KN..150410R	SM872	MS111	2	CM66	MS625	4
NKNNR2525M15	25	25	12,0	150	37,0	-	-2,0	-5,0	KN..150410R	SM872	MS111	2	CM66	MS625	4
Links															
NKNNL2020K15	20	20	12,0	125	37,0	-	-2,0	-5,0	KN..150410L	SM871	MS111	2	CM66	MS625	4
NKNNL2525M15	25	25	12,0	150	37,0	-	-2,0	-5,0	KN..150410L	SM871	MS111	2	CM66	MS625	4
Rechts															
NKXCR1212F11	12	12	16,0	80	27,0	-	0,0	0,0	KC..110305L	SM886	MS959	-	CM68	MS524	3
NKXCR1616H11	16	16	20,0	100	27,0	-	0,0	0,0	KC..110305L	SM886	MS959	-	CM68	MS524	3
Links															
NKXCL1212F11	12	12	16,0	80	27,0	-	0,0	0,0	KC..110305R	SM885	MS959	-	CM68	MS524	3
NKXCL1616H11	16	16	20,0	100	27,0	-	0,0	0,0	KC..110305R	SM885	MS959	-	CM68	MS524	3

NKXN 120°

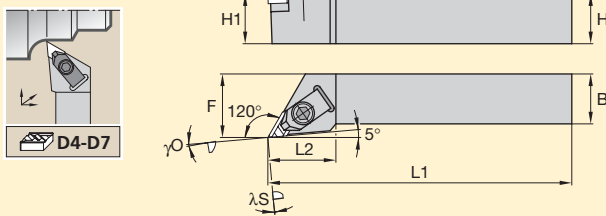

NVHB 107,5°

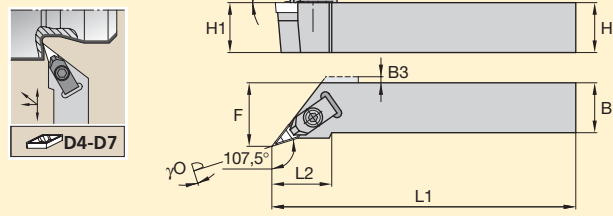

ISO-Katalognummer	H = H1	B	F	L1	L2	B3	λS°	γ0°	Wende- schneid- platte	Unter- lage	Schraube für Unter- lage Hex (mm)	Spann- element	Schraube für Spann- element Hex (mm)		
Rechts															
NKXNR2020K15	20	20	25,0	125	35,0	-	-2,0	-5,0	KN..150410L	SM871	MS111	2	CM66	MS625	4
NKXNR2525M15	25	25	32,0	150	35,0	-	-2,0	-5,0	KN..150410L	SM871	MS111	2	CM66	MS625	4
Links															
NKXNL2020K15	20	20	25,0	125	35,0	-	-2,0	-5,0	KN..150410R	SM872	MS111	2	CM66	MS625	4
NKXNL2525M15	25	25	32,0	150	35,0	-	-2,0	-5,0	KN..150410R	SM872	MS111	2	CM66	MS625	4
Rechts															
NVHBR1616H11	16	16	20,0	100	25,0	3,0	0,0	0,0	VB..110304	SM813	MS959	-	CM158	MS518	4
NVHBR2020K11	20	20	25,0	125	30,0	-	0,0	0,0	VB..110304	SM813	MS959	-	CM158	MS518	2,5
NVHBR2525M11	25	25	32,0	150	30,0	-	0,0	0,0	VB..110304	SM813	MS959	-	CM158	MS518	2,5
Links															
NVHBL1616H11	16	16	20,0	100	25,0	3,0	0,0	0,0	VB..110304	SM813	MS959	-	CM159	MS518	4
NVHBL2020K11	20	20	25,0	125	30,0	-	0,0	0,0	VB..110304	SM813	MS959	-	CM159	MS518	2,5
NVHBL2525M11	25	25	32,0	150	30,0	-	0,0	0,0	VB..110304	SM813	MS959	-	CM159	MS518	2,5

Bestellbeispiel:
Rechts: NKNNR2020K15



Links: NKNNL2020K15



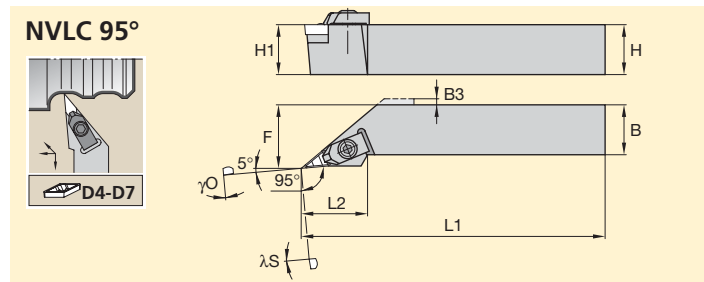
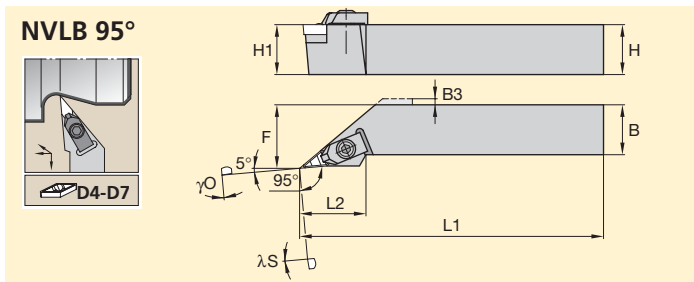

ISO-Katalognummer	H =		F	L1	L2	B3	λS°	γ0°	Wende-schneid-platte	Unter-lage	Schraube für Unter-lage		Spann-element	Schraube für Spann-element		
	H1	B									Hex (mm)	Hex (mm)				
Rechts																
NVLBR1212N11	12	12	16,0	160	25,0	4,0	0,0	0,0	VB..110304	SM813	MS959	-	CM158	MS518	2,5	
NVLBR1616H11	16	16	20,0	100	25,0	-	0,0	0,0	VB..110304	SM813	MS959	-	CM158	MS518	2,5	
NVLBR2020K11	20	20	25,0	125	30,0	-	0,0	0,0	VB..110304	SM813	MS959	-	CM158	MS518	2,5	
NVLBR2525M11	25	25	32,0	150	32,0	-	0,0	0,0	VB..110304	SM813	MS959	-	CM158	MS518	2,5	
Links																
NVLBL1212N11	12	12	16,0	160	25,0	4,0	0,0	0,0	VB..110304	SM813	MS959	-	CM159	MS518	2,5	
NVLBL1616H11	16	16	20,0	100	25,0	-	0,0	0,0	VB..110304	SM813	MS959	-	CM159	MS518	2,5	
NVLBL2020K11	20	20	25,0	125	30,0	-	0,0	0,0	VB..110304	SM813	MS959	-	CM159	MS518	2,5	
NVLBL2525M11	25	25	32,0	150	32,0	-	0,0	0,0	VB..110304	SM813	MS959	-	CM159	MS518	2,5	
Rechts																
NVLCR1616H16	16	16	20,0	100	37,0	5,0	0,0	0,0	VC..160408	SM812	MS959	-	CM113	MS412	4	
NVLCR2020K16	20	20	25,0	125	37,0	-	0,0	0,0	VC..160408	SM812	MS959	-	CM113	MS412	4	
NVLCR2525M16	25	25	32,0	150	37,0	-	0,0	0,0	VC..160408	SM812	MS959	-	CM113	MS412	4	
NVLCR3225P16	32	25	32,0	170	37,0	-	0,0	0,0	VC..160408	SM812	MS959	-	CM113	MS412	4	
Links																
NVLCCL1616H16	16	16	20,0	100	37,0	5,0	0,0	0,0	VC..160408	SM812	MS959	-	CM114	MS412	4	
NVLCCL2020K16	20	20	25,0	125	37,0	-	0,0	0,0	VC..160408	SM812	MS959	-	CM114	MS412	4	
NVLCCL2525M16	25	25	32,0	150	37,0	-	0,0	0,0	VC..160408	SM812	MS959	-	CM114	MS412	4	
NVLCCL3225P16	32	25	32,0	170	37,0	-	0,0	0,0	VC..160408	SM812	MS959	-	CM114	MS412	4	

NVOC 117,5°

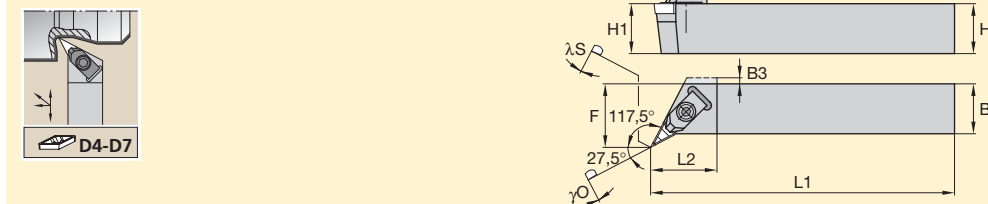

ISO-Katalognummer	H =		F	L1	L2	B3	λS°	γ0°	Wende-schneid-platte	Unter-lage	Schraube für Unter-lage		Spann-element	Schraube für Spann-element		
	H1	B									Hex (mm)	Hex (mm)				
Rechts																
NVOCR2020K16	20	20	32,0	125	29,0	3,0	0,0	0,0	VC..160408	SM812	MS959	-	CM113	MS412	4	
NVOCR2525M16	25	25	32,0	150	29,0	3,0	0,0	0,0	VC..160408	SM812	MS959	-	CM113	MS412	4	
Links																
NVOCL2020K16	20	20	32,0	125	29,0	3,0	0,0	0,0	VC..160408	SM812	MS959	-	CM114	MS412	4	
NVOCL2525M16	25	25	32,0	150	29,0	3,0	0,0	0,0	VC..160408	SM812	MS959	-	CM114	MS412	4	

Bestellbeispiel:
Rechts: NVLBR1212N11



Links: NVLBL1212N11



TOP NOTCH PROFILING



Klemmhalter

NVVB 72,5°

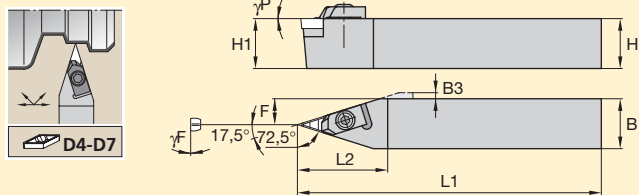

NVVC 72,5°

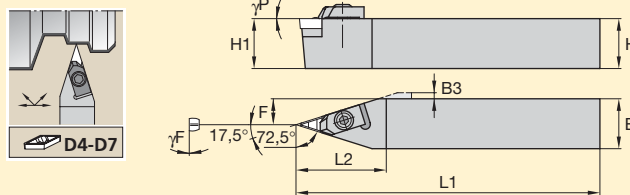

ISO-Katalognummer	H =			L1	L2	B3	γ_F°	γ_P°	Wende-schneid-platte	Unter-lage	Schraube für Unter-lage	Hex (mm)	Spann-element	Schraube für Spann-element	Hex (mm)
	H1	B	F												
NVVB1616H11	16	16	7,9	100	30,0	2,0	0,0	0,0	VB..110304	SM813	MS959	-	CM158	MS518	4
NVVB2020K11	20	20	10,0	125	30,0	-	0,0	0,0	VB..110304	SM813	MS959	-	CM158	MS518	2,5
NVVB2525M11	25	25	12,5	150	30,0	-	0,0	0,0	VB..110304	SM813	MS959	-	CM158	MS518	2,5
NVVC1616H16	16	16	8,0	100	42,0	4,0	0,0	0,0	VC..160408	SM812	MS959	-	CM113	MS412	4
NVVC2020K16	20	20	10,0	125	42,0	2,0	0,0	0,0	VC..160408	SM812	MS959	-	CM113	MS412	4
NVVC2525M16	25	25	12,5	150	42,0	-	0,0	0,0	VC..160408	SM812	MS959	-	CM113	MS412	4

Bestellbeispiel:
NVVB1616H11

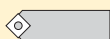



A-NKLC 95°

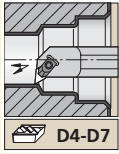

Stahlschaft mit Innenkühlung

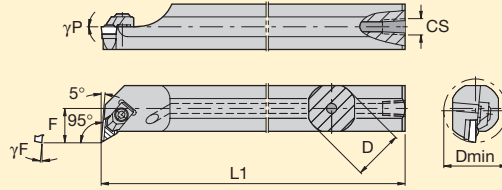

ISO-Katalognummer	D	Dmin	F	L1	L	L1A	A	CS	γF°	γP°	Wende-schneid-platte						
												Unter-lage	Schraube für Unter-lage	Hex (mm)	Spann-element	Schraube für Spann-element	Hex (mm)
Rechts																	
A12MNKLCR11	12	16,0	9,0	150	-	-	-	1/16-27 NPT	-5,0	0,0	KC..110305L	-	-	-	CM106	MS518	2,5
A16MNKLCR11	16	20,0	11,0	150	-	-	-	1/8-27 NPT	-7,0	0,0	KC..110305L	SM886	MS959	-	CM106	MS518	2,5
A20QNKLCR11	20	25,0	13,0	180	-	-	-	1/8-27 NPT	-5,0	0,0	KC..110305L	SM886	MS959	-	CM68	MS524	3
A25RNKLCR11	25	32,0	16,0	200	-	-	-	1/4-18 NPT	-5,0	0,0	KC..110305L	SM886	MS959	-	CM68	MS524	3
A32SNKLCR11	32	40,0	22,0	250	-	-	-	1/4-18 NPT	-5,0	0,0	KC..110305L	SM886	MS959	-	CM68	MS524	3
Links																	
A12MNKLCL11	12	16,0	9,0	150	-	-	-	1/16-27 NPT	-5,0	0,0	KC..110305R	-	-	-	CM106	MS518	2,5
A16MNKLCL11	16	20,0	11,0	150	-	-	-	1/8-27 NPT	-7,0	0,0	KC..110305R	SM885	MS959	-	CM105	MS518	2,5
A20QNKLCL11	20	25,0	13,0	180	-	-	-	1/8-27 NPT	-5,0	0,0	KC..110305R	SM885	MS959	-	CM68	MS524	3
A25RNKLCL11	25	32,0	16,0	200	-	-	-	1/4-18 NPT	-5,0	0,0	KC..110305R	SM885	MS959	-	CM68	MS524	3
A32SNKLCL11	32	40,0	22,0	250	-	-	-	1/4-18 NPT	-5,0	0,0	KC..110305R	SM885	MS959	-	CM68	MS524	3

E-NKLC 95°

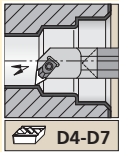

Hartmetallschaft mit Innenkühlung

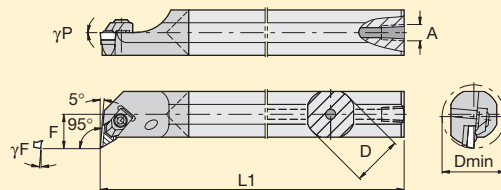

ISO-Katalognummer	D	Dmin	F	L1	L	L1A	A	CS	γF°	γP°	Wende-schneid-platte						
												Unter-lage	Schraube für Unter-lage	Hex (mm)	Spann-element	Schraube für Spann-element	Hex (mm)
Rechts																	
E12QNKLCR11	12	16,0	9,0	180	-	-	4,8	-	-5,0	0,0	KC..110308L	-	-	-	CM106	MS518	2,5
E16RNKLCR11	16	20,0	11,0	200	-	-	5,5	-	-5,0	0,0	KC..110308L	SM886	MS959	-	CM106	MS518	2,5
E20SNKLCR11	20	25,0	13,0	250	-	-	7,1	-	-5,0	0,0	KC..110308L	SM886	MS959	-	CM68	MS524	3
Links																	
E12QNKLCL11	12	16,0	9,0	180	-	-	4,8	-	-5,0	0,0	KC..110308R	-	-	-	CM105	MS518	2,5
E16RNKLCL11	16	20,0	11,0	200	-	-	5,5	-	-5,0	0,0	KC..110308R	SM885	MS959	-	CM105	MS518	2,5
E20SNKLCL11	20	25,0	13,0	250	-	-	7,1	-	-5,0	0,0	KC..110308R	SM885	MS959	-	CM68	MS524	3

Bestellbeispiel:
Rechts: A12MNKLCR11



Links: A12MNKLCL11





A-NKLN 95°

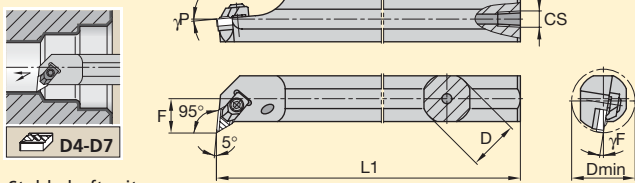

Stahlschaft mit Innenkühlung

A-NKXC 90°

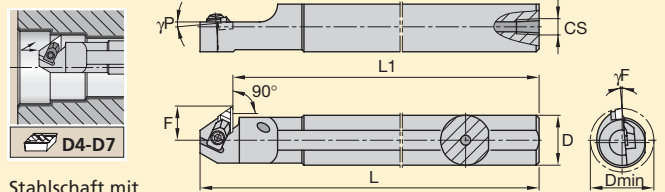

Stahlschaft mit Innenkühlung

ISO-Katalognummer	D	Dmin	F	L1	L	L1A	A	CS	γ_F°	γ_P°	Wende-schneid-platte	Unter-lage	Schraube für Unterlage	Hex (mm)	Spann-element	Schraube für Spann-element	Hex (mm) Torx
Rechts																	
A25RNKLN15	25	32,0	17,0	200	-	-	-	1/4-18 NPT	-9,0	-5,0	KN..150410L	SM871	MS111	2	CM77	MS1221	T25
A32SNKLN15	32	40,0	22,0	250	-	-	-	1/4-18 NPT	-9,0	-5,0	KN..150410L	SM871	MS111	2	CM66	MS624	4
A40TNKLN15	40	50,0	27,0	300	-	-	-	1/4-18 NPT	-5,0	-5,0	KN..150410L	SM871	MS111	2	CM66	MS624	4
Links																	
A25RNKLN15	25	32,0	17,0	200	-	-	-	1/4-18 NPT	-9,0	-5,0	KN..150410R	SM872	MS111	2	CM69	MS1221	T25
A32SNKLN15	32	40,0	22,0	250	-	-	-	1/4-18 NPT	-9,0	-5,0	KN..150410R	SM872	MS111	2	CM66	MS624	4
A40TNKLN15	40	50,0	27,0	300	-	-	-	1/4-18 NPT	-5,0	-5,0	KN..150410R	SM872	MS111	2	CM66	MS624	4
A20QNKC11	20	25,0	13,0	180	199	-	-	1/8-27 NPT	-5,0	-5,0	KC..110305R	SM886	MS959	-	CM79	MS1220	T25
A25RNKC11	25	32,0	17,0	200	219	-	-	1/4-18 NPT	-5,0	-5,0	KC..110305R	SM886	MS959	-	CM68	MS524	3

A-NVLB 95°

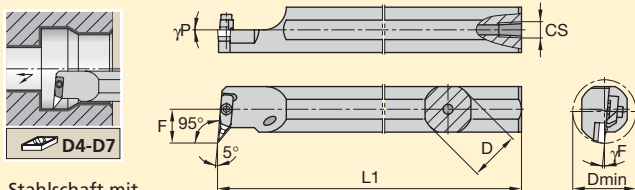

Stahlschaft mit Innenkühlung

A-NVOC 117,5°

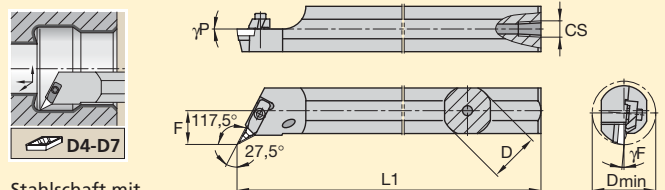

Stahlschaft mit Innenkühlung

ISO-Katalognummer	D	Dmin	F	L1	L	L1A	A	CS	γ_F°	γ_P°	Wende-schneid-platte	Unter-lage	Schraube für Unterlage	Hex (mm)	Spann-element	Schraube für Spann-element	Hex (mm)
Rechts																	
A20SNVBR11	20	26,0	13,0	250	-	-	-	1/8-27 NPT	-5,0	0,0	VB..110304	SM813	MS959	-	CM159	MS518	2,5
A25TNVBR11	25	32,0	17,0	300	-	-	-	1/4-18 NPT	-5,0	0,0	VB..110304	SM813	MS959	-	CM159	MS518	2,5
Links																	
A20SNVBL11	20	26,0	13,0	250	-	-	-	1/8-27 NPT	-5,0	0,0	VB..110304	SM813	MS959	-	CM158	MS518	2,5
A25TNVBL11	25	32,0	17,0	300	-	-	-	1/4-18 NPT	-5,0	0,0	VB..110304	SM813	MS959	-	CM158	MS518	2,5
Rechts																	
A32SNVOCR16	32	40,0	22,0	250	-	-	-	1/4-18 NPT	-2,0	0,0	VC..160408	SM812	MS959	-	CM113	MS412	4
A40TNVOCR16	40	50,0	27,0	300	-	-	-	1/4-18 NPT	-2,0	0,0	VC..160408	SM812	MS959	-	CM113	MS412	4
A50UNVOCR16	50	63,0	35,0	350	-	-	-	1/4-18 NPT	-2,0	0,0	VC..160408	SM812	MS959	-	CM113	MS412	4
Links																	
A32SNVOC16	32	40,0	22,0	250	-	-	-	1/4-18 NPT	-2,0	0,0	VC..160408	SM812	MS959	-	CM114	MS412	4
A40TNVOC16	40	50,0	27,0	300	-	-	-	1/4-18 NPT	-2,0	0,0	VC..160408	SM812	MS959	-	CM114	MS412	4
A50UNVOC16	50	63,0	35,0	350	-	-	-	1/4-18 NPT	-2,0	0,0	VC..160408	SM812	MS959	-	CM114	MS412	4

Bestellbeispiel:
Rechts: A25RNKLN15



Links: A25RNKLN15



TOP NOTCH PROFILING



Bohrstangen

A-NVQB 107,5°

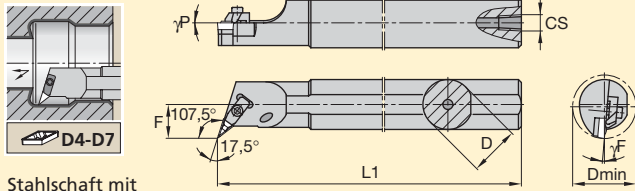

Stahlschaft mit
Innenkühlung

A-NVQC 107,5°

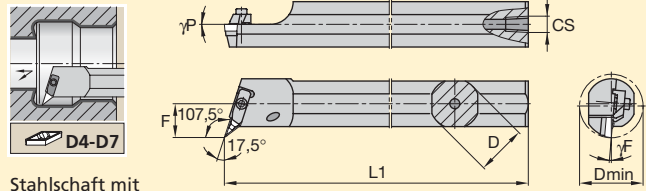

Stahlschaft mit
Innenkühlung

ISO-Katalognummer	D	Dmin	F	L1	L	L1A	A	CS	γF°	γP°	Wende- schneid- platte	Schraube						
												Unter- lage	Schraube für Unter- lage	Hex (mm)	Spann- element	Schraube für Spann- element	Hex (mm)	
Rechts																		
A16RNVQBR11	16	20,00	11,0	200	-	-	-	1/8-27 NPT	-5,0	0,0	VB..110304	SM813	MS959	-	CM159	MS518	2,5	
A20SNVQBR11	20	25,00	13,0	250	-	-	-	1/8-27 NPT	-5,0	0,0	VB..110304	SM813	MS959	-	CM159	MS518	2,5	
A25TNVQBR11	25	32,00	17,0	300	-	-	-	1/4-18 NPT	-5,0	0,0	VB..110304	SM813	MS959	-	CM159	MS518	2,5	
Links																		
A16RNVQBL11	16	20,00	11,0	200	-	-	-	1/8-27 NPT	-5,0	0,0	VB..110304	SM813	MS959	-	CM158	MS518	2,5	
A20SNVQBL11	20	25,00	13,0	250	-	-	-	1/8-27 NPT	-5,0	0,0	VB..110304	SM813	MS959	-	CM158	MS518	2,5	
A25TNVQBL11	25	32,00	17,0	300	-	-	-	1/4-18 NPT	-5,0	0,0	VB..110304	SM813	MS959	-	CM158	MS518	2,5	
Rechts																		
A32SNVQCR16	32	40,00	22,0	250	-	-	-	1/4-18 NPT	-2,0	0,0	VC..160408	SM812	MS959	-	CM113	MS412	4	
A40TNVQCR16	40	50,00	27,0	300	-	-	-	1/4-18 NPT	-2,0	0,0	VC..160408	SM812	MS959	-	CM113	MS412	4	
A50UNVQCR16	50	63,00	35,0	350	-	-	-	1/4-18 NPT	-2,0	0,0	VC..160408	SM812	MS959	-	CM113	MS412	4	
Links																		
A32SNVQCL16	32	40,00	22,0	250	-	-	-	1/4-18 NPT	-2,0	0,0	VC..160408	SM812	MS959	-	CM114	MS412	4	
A40TNVQCL16	40	50,00	27,0	300	-	-	-	1/4-18 NPT	-2,0	0,0	VC..160408	SM812	MS959	-	CM114	MS412	4	
A50UNVQCL16	50	63,00	35,0	350	-	-	-	1/4-18 NPT	-2,0	0,0	VC..160408	SM812	MS959	-	CM114	MS412	4	

A-NVVB 72,5°

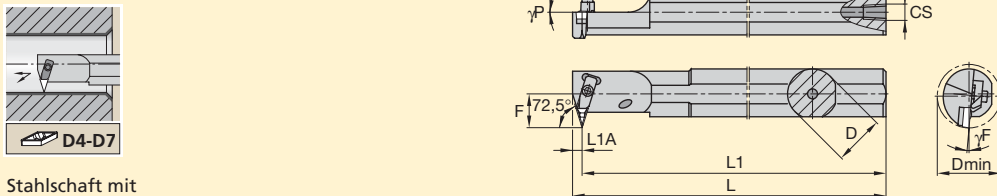

Stahlschaft mit
Innenkühlung

ISO-Katalognummer	D	Dmin	F	L1	L	L1A	A	CS	γF°	γP°	Wende- schneid- platte	Schraube						
												Unter- lage	Schraube für Unter- lage	Hex (mm)	Spann- element	Schraube für Spann- element	Hex (mm)	
Rechts																		
A25TNVVB11	25	32,00	17,0	300	306,6	6,6	-	1/4-18 NPT	-5,0	0,0	VB..110304	SM813	MS959	-	CM159	MS518	2,5	
Links																		
A25TNVVB11	25	32,00	17,0	300	306,6	6,6	-	1/4-18 NPT	-5,0	0,0	VB..110304	SM813	MS959	-	CM158	MS518	2,5	

Bestellbeispiel:
Rechts: A16RNVQBR11



Links: A16RNVQBL11





H-NKLC 95°

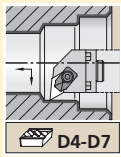

Mit
Innenkühlung

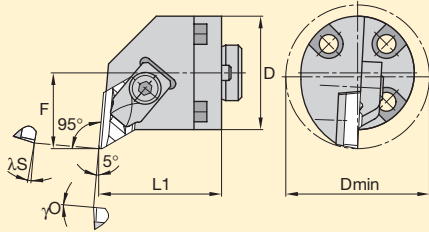

H-NKLN 95°

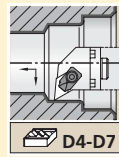

Mit
Innenkühlung

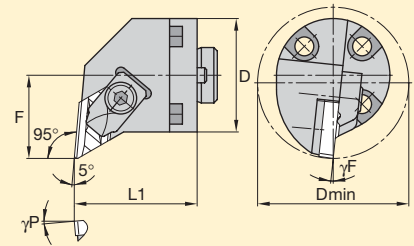

ISO-Katalognummer	D	Dmin	F	L1	λS°	γF°	γP°	γO°	Wende- schneid- platte	Unter- lage	Schraube für Unter- lage	Hex (mm)	Spann- element	Schraube für Spann- element	Hex (mm)
Rechts H25NKLCR11	25	32	17	41	-5,0	-	-	0,0	KC..110305L	SM886	MS959	-	CM68	MS524	3
Links H25NKLCL11	25	32	17	41	-5,0	-	-	0,0	KC..110305R	SM885	MS959	-	CM68	MS524	3
Rechts H32NKLN R15	32	40	22	41	-	-6,0	-5,0	-	KN..150410L	SM871	MS111	2	CM66	MS624	4
H40NKLN R15	40	50	27	41	-	-3,0	-5,0	-	KN..150410L	SM871	MS111	2	CM66	MS625	4
Links H32NKLN L15	32	40	22	41	-	-6,0	-5,0	-	KN..150410R	SM872	MS111	2	CM66	MS624	4
H40NKLN L15	40	50	27	41	-	-3,0	-5,0	-	KN..150410R	SM872	MS111	2	CM66	MS625	4

Bestellbeispiel:
Rechts: H25NKLCR11



Links: H25NKLCL11

